

## Assembly view

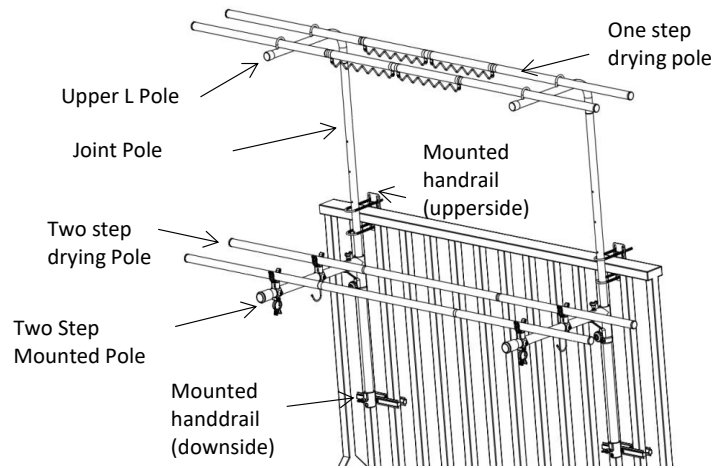

### 1, Both side pole assembly (A)

- ① Square nut into the two step pole and mounted
- ② 1,2,3 adjust hole and placed bold and tighten the nut

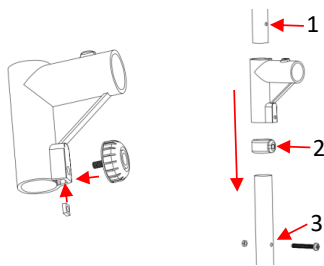

### 2, Both side L pole assembly (B)

- ① L pole place joint pole and tightened

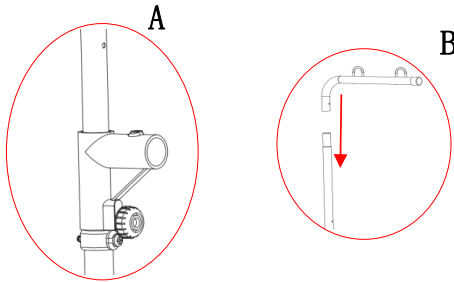

### 3, Mounted handrail (downside) assembly (C)

- ① Honey Nut place into the mounted and tightened with nut.
- ② V type nut and washer placed mounted handrail and tightened
- ③ Mounted handrail distance must be longer than pole distance.
- ④ Mounted hadrail (downside) placed into the mounted and tightned with Pole Nut

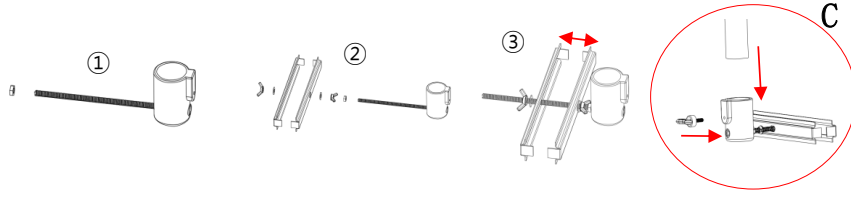

### 4, Two step pole assembly

- ① Assembled mounted handrail (downside) placed hadrail with V type Nut and tightened
  - ② Upper U type screw placed both up and down and V type nut tight
- (Vertical arrange is very important)

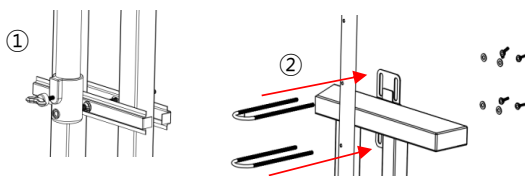

### 5, Two step pole assembly

- ① Stainless pole placed into mounted and tightned with Pole screw.

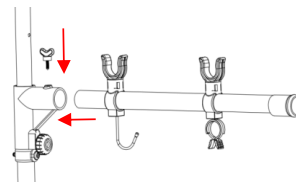

### 6, Assembly drying pole

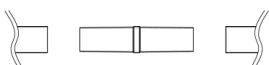

Two main drying pole with one joint pole  
Main drying pole length 600mm

### 7, Drying pole assembly

- ① Placed down side drying pole Mounthed handrail (downsite), Also placed upper side L pole into the U type hole.

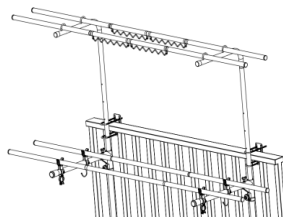

### 8, Folding view of Downside pole.

